



Origami by Filament

Ilan Garibi

Ann Arbor, Michigan, USA

CFC 6

May 14-17, 2026

Star Trek™ Replicator



Prusa MK4S

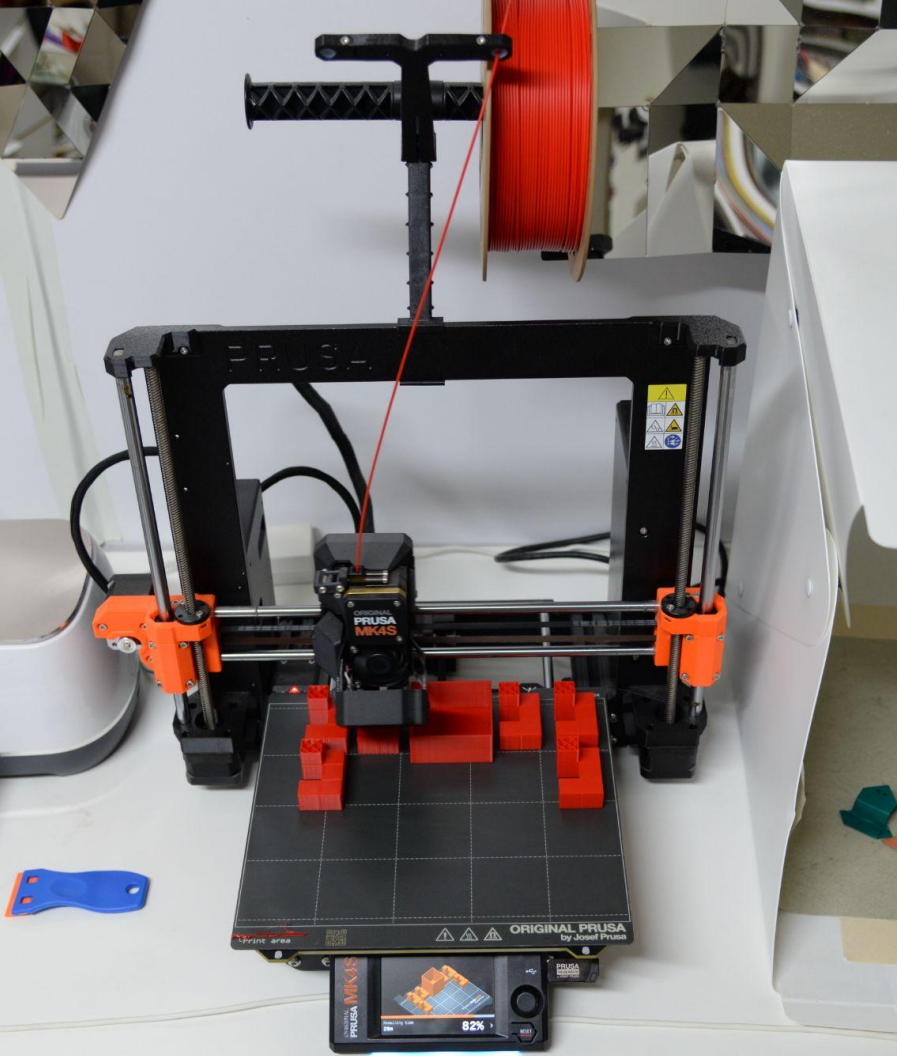

Legend

Feature type	Time	Percentage	Used filament
Perimeter	18m	28.3%	4.32 m 12.89 g
External perimeter	19m	28.5%	5.29 m 15.77 g
Overhang perimeter	0s	0.0%	0.00 m 0.00 g
Internal infill	6m	9.2%	1.17 m 3.50 g
Solid infill	10m	15.6%	2.37 m 7.06 g
Top solid infill	2m	3.6%	0.36 m 1.07 g
Bridge infill	1m	1.8%	0.14 m 0.43 g
Custom	5s	0.1%	0.02 m 0.06 g

Estimated printing times [Normal mode]:
 First layer: 3m
 Total: 1h5m
 Show stealth mode

Prusa Slicer

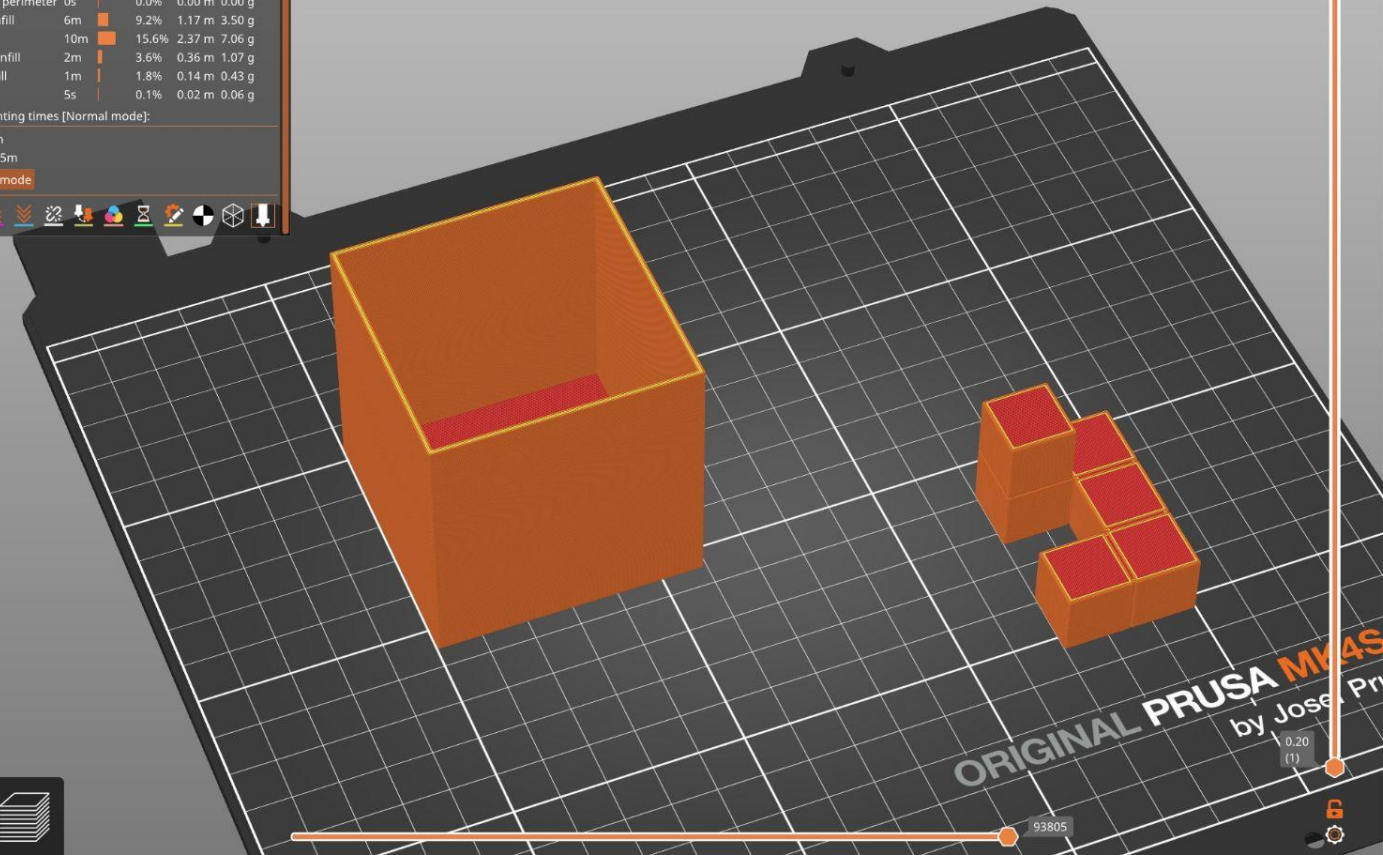

Print settings:

0.20mm SPEED

Filament: Generic PLA

Printer: Original Prusa MK4S 0.4 nozzle

Supports: For support enforcers only

Infill: 15% Brim:

Name	Editing
3.1.11 36 Cubes ...X 3D Print.stl_1	
3.1.11 36 Cubes ...X 3D Print.stl_2	

Sliced Info

Used Filament (g) 40.77
 Used Filament (m) 13.67
 Used Filament (mm³) 32883.03
 Cost 1.04
 Estimated printing time:
 - normal mode 1h5m
 - stealth mode 1h17m



BYU Resource Page



Watch Video

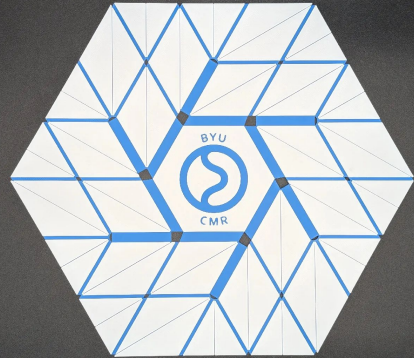

Download and 3D Print Compliant Mechanism Designs

View, download, and make your own compliant mechanism or origami patterns. Find fun projects to do at home or in the classroom.

[Start Creating](#)



BYU CMR



LSD in Motion

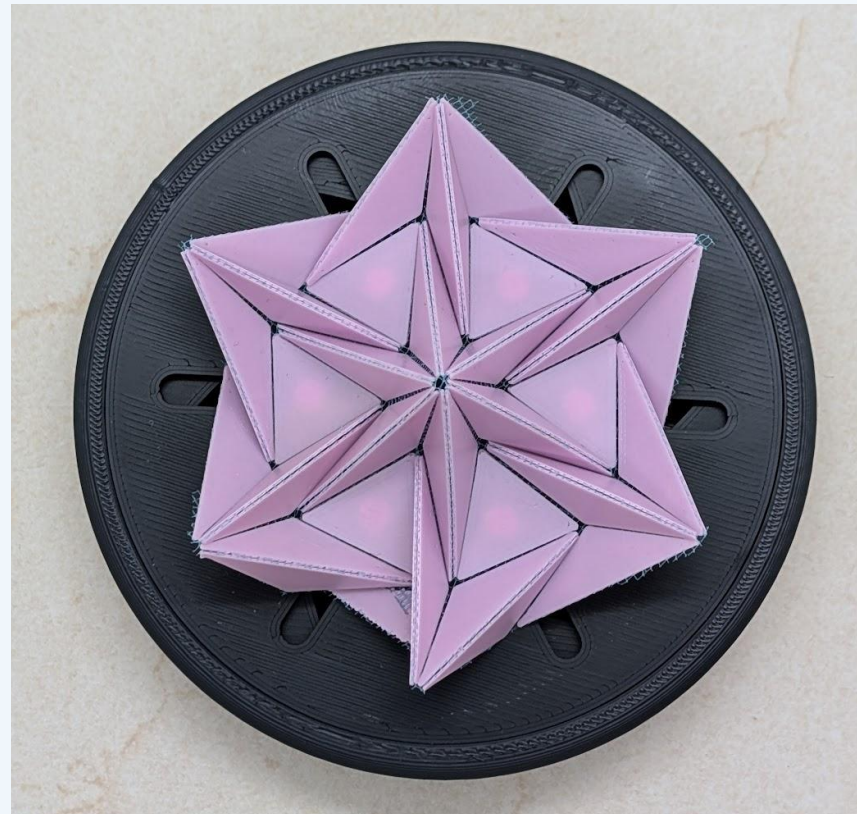

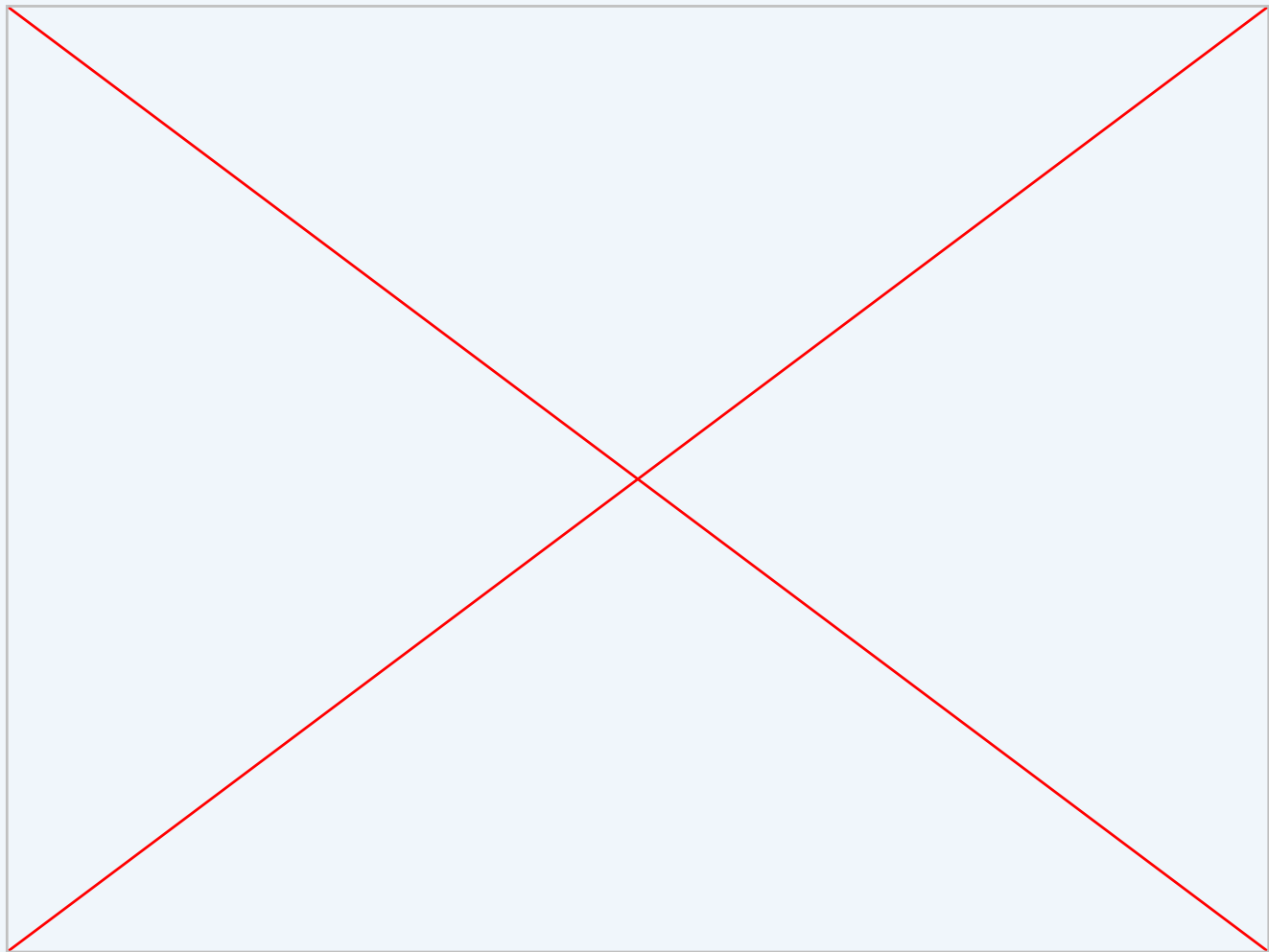

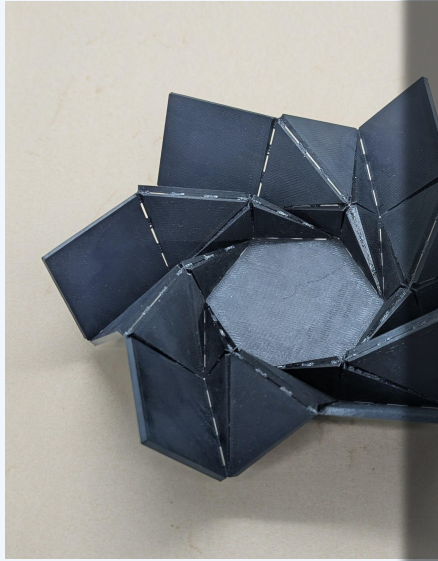

Folded Models

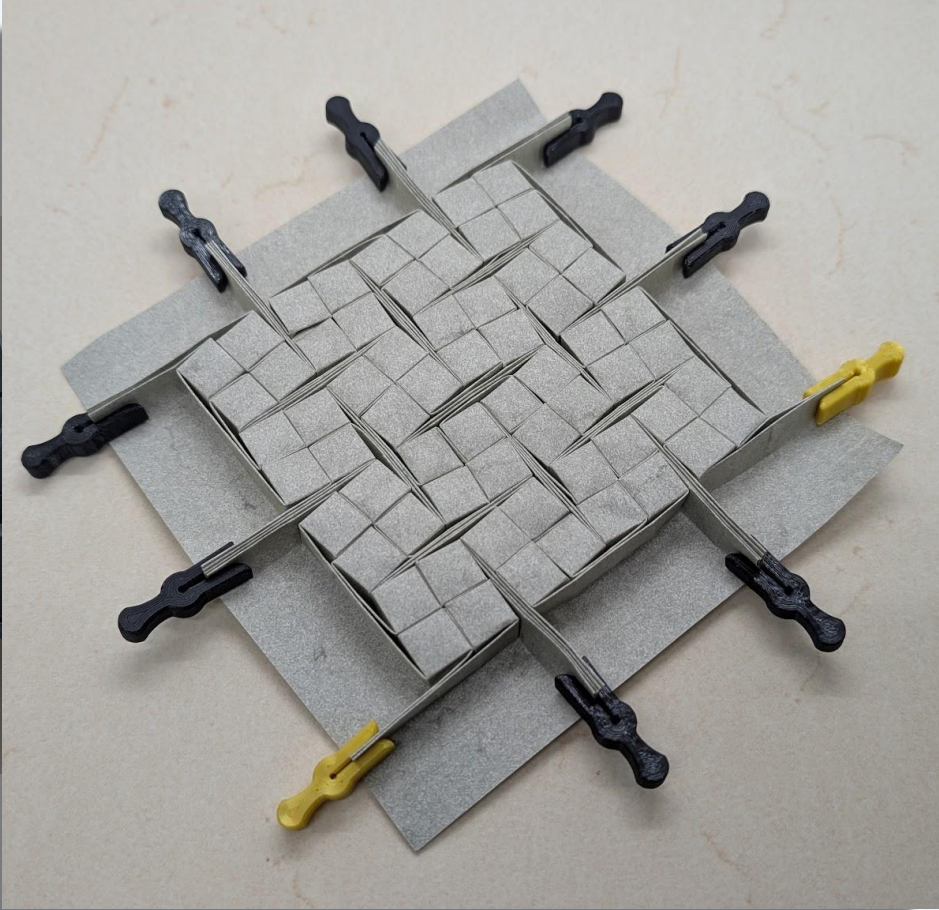

Peripherals

Folding Accessories

Visually-Impaired-Folders' Tool, by Ynon Toledano



1 Snap

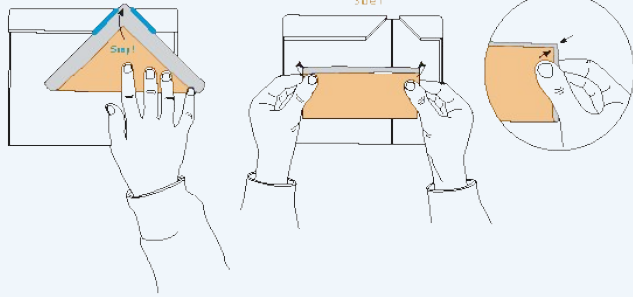

2 Press

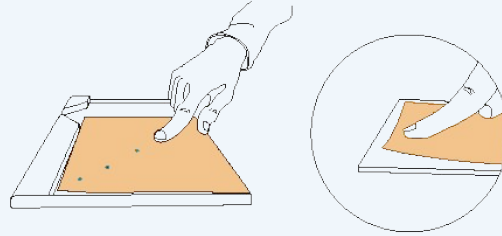

3 Fold

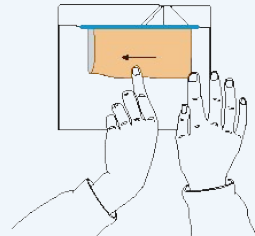
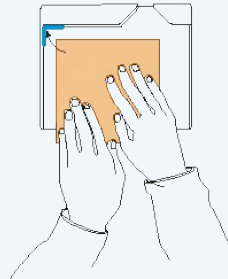

4 Cut

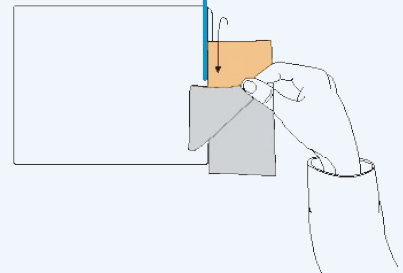
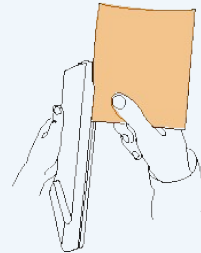

The Design - Templates

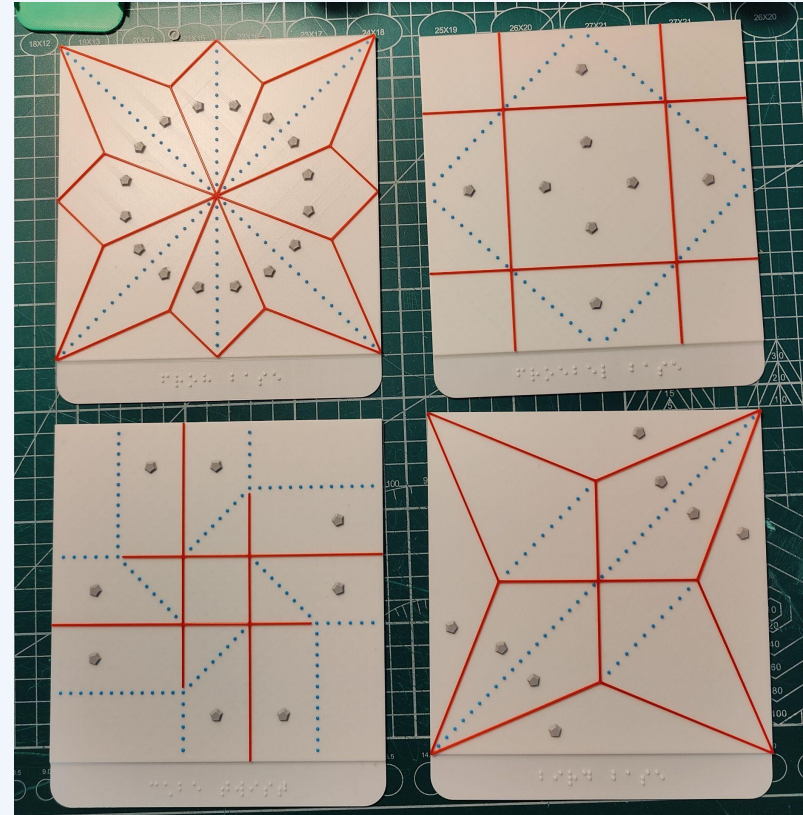
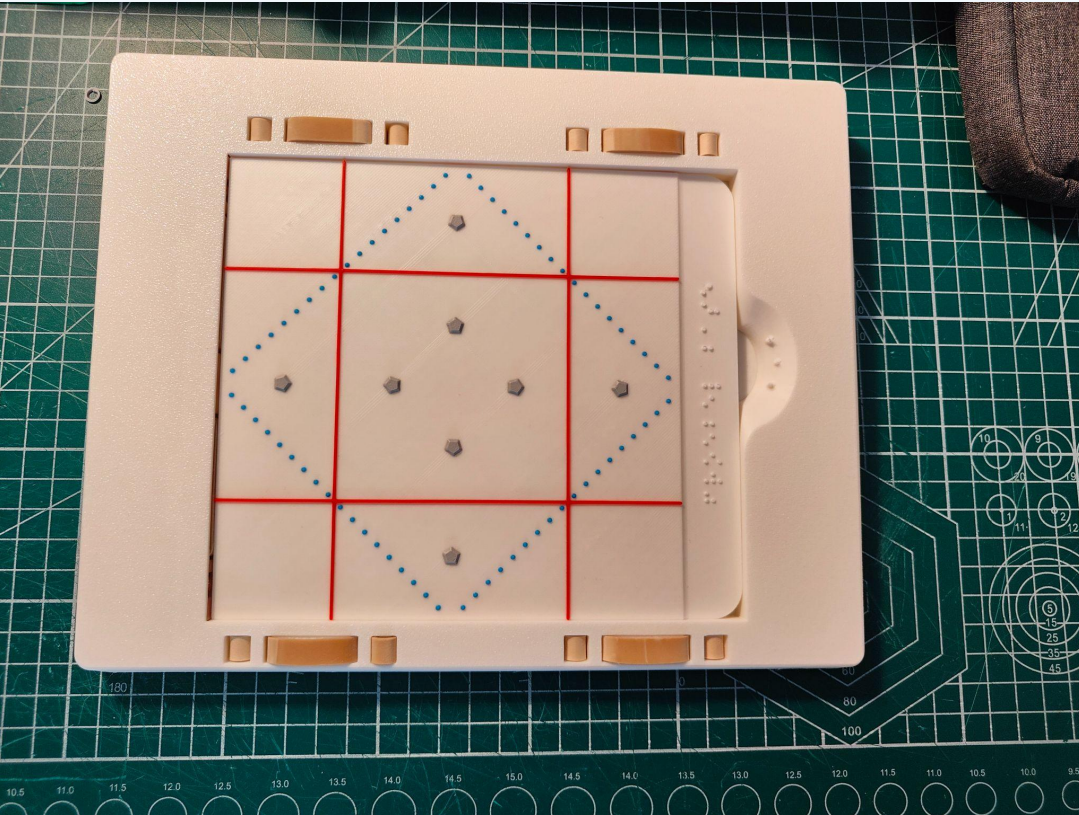

Paper Clips

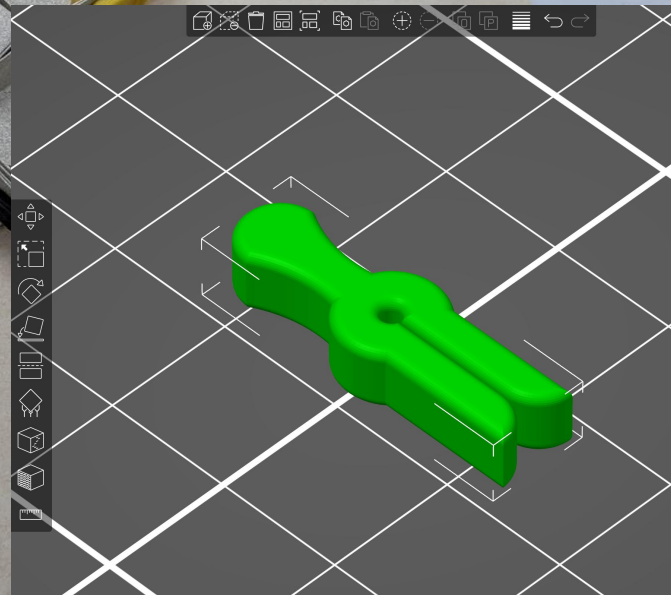
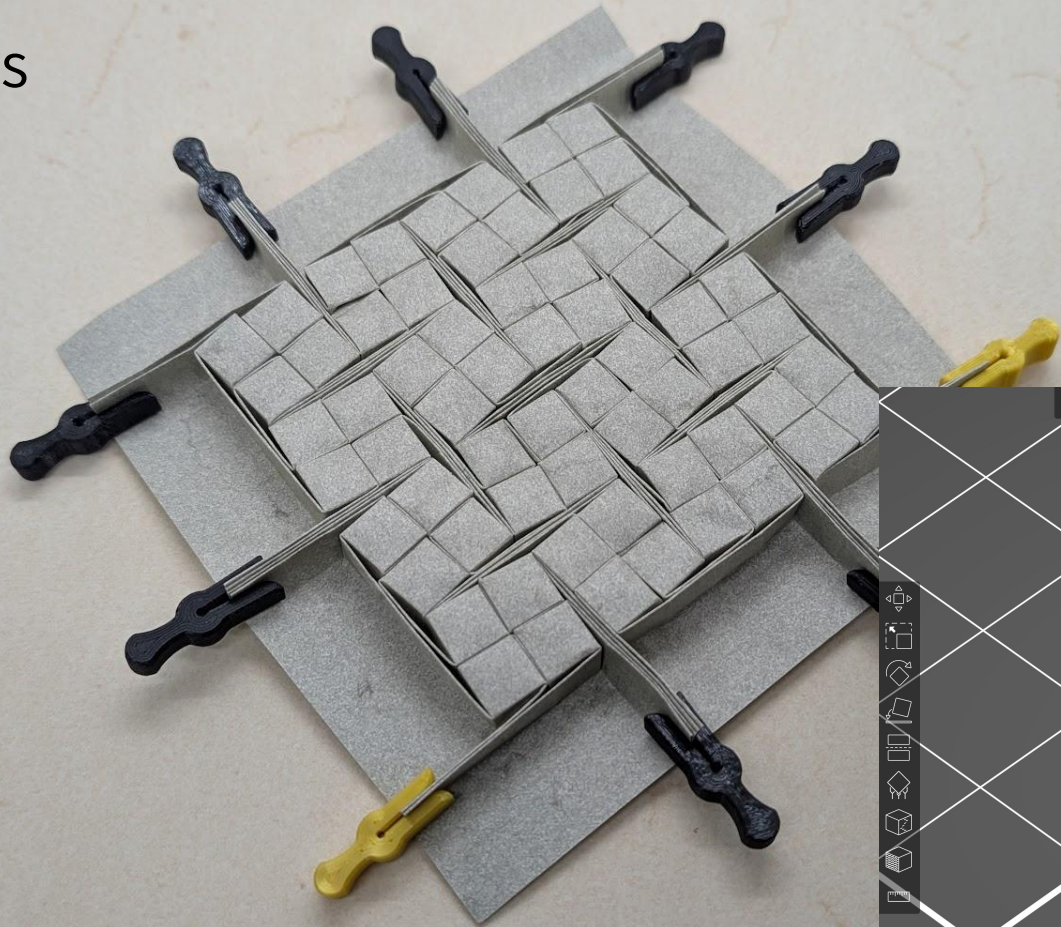

Third Finder

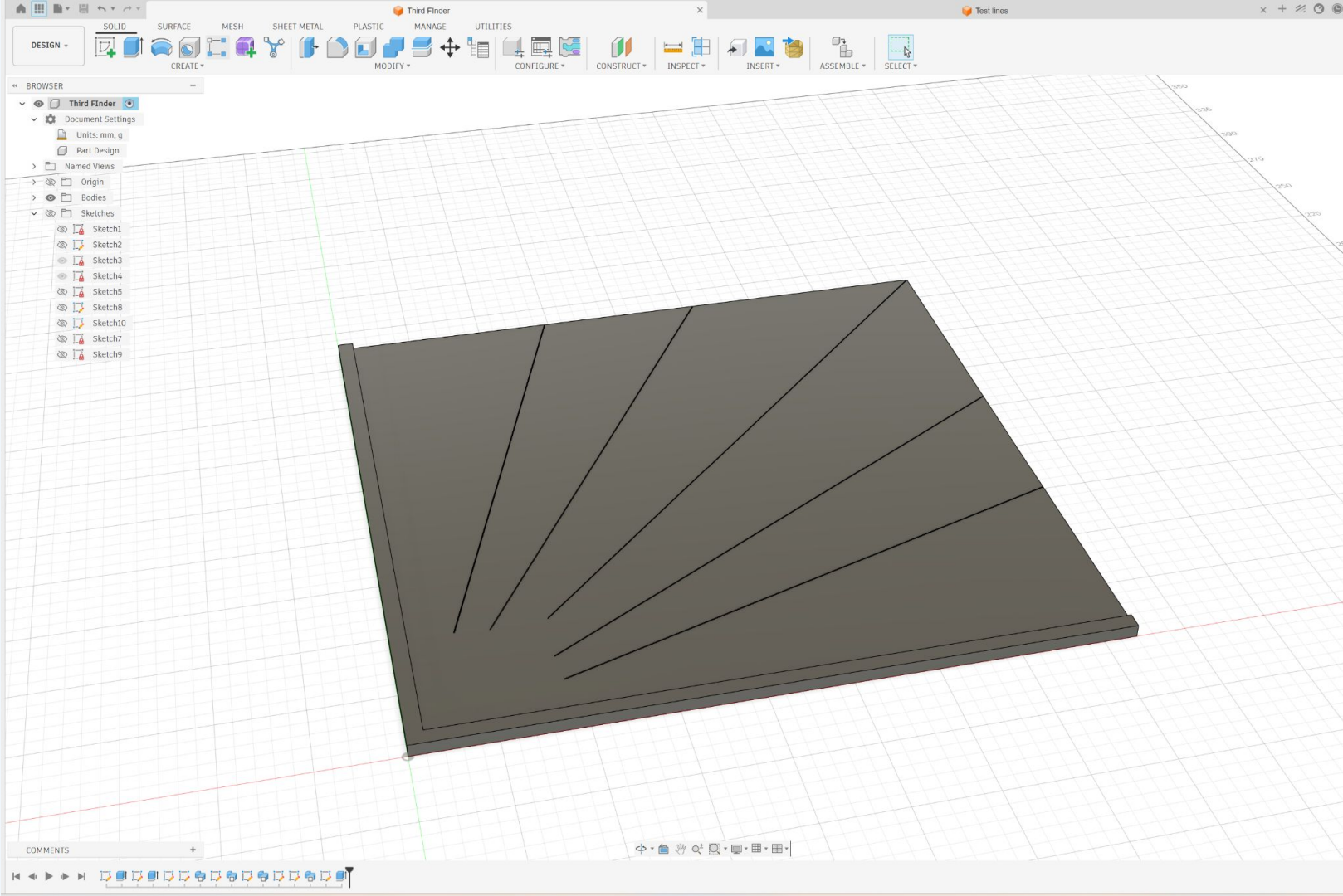

Curved Tess Templates

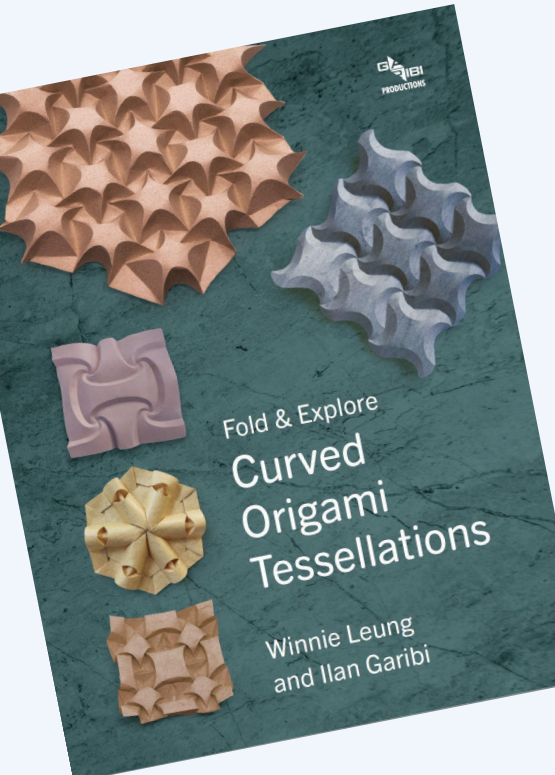

Bone Folder

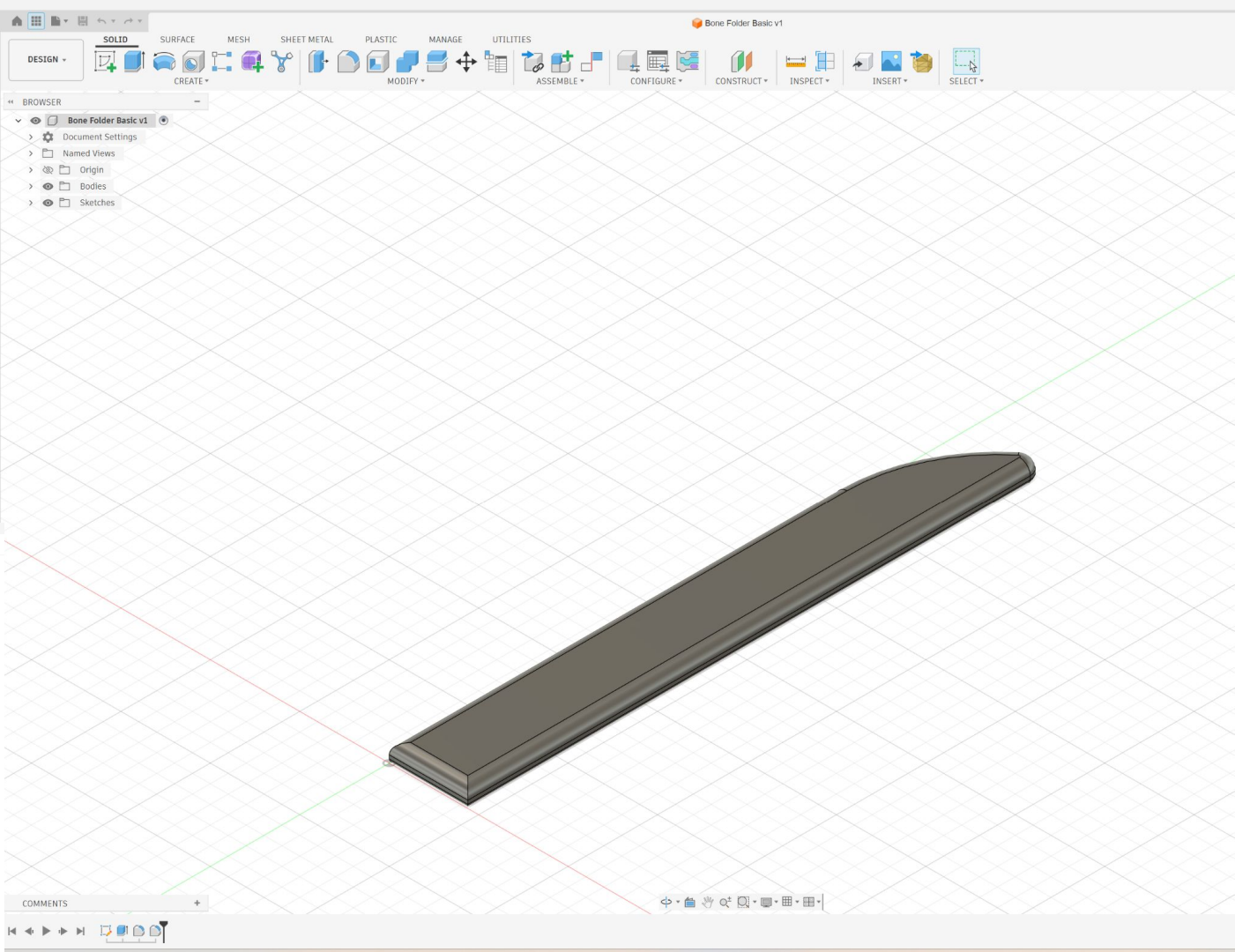

Shipping to Israel, 2025120, 04years - Reduced Shipping for CORE Club!

US - English - Login

PRUSA 3D printers Materials Parts & Accessories For Business Software 3D Models Community Help Courses Blog Company

Filament

Prusament	Materials appearance look	Safety 3D Side	Filament Bundles	PLA	PETG
PC (Polycarbonate)	ASA / ABS	PA Nylon	Composites	Fibres	Special
Ess					

Filter by: Manufacturer Filament color NFC compatibility Opacity Spool type Sort by: Recommended



Prusament PETG Prusa Pro Green 1kg (NFC) ★★★★★ In stock \$105.00 Buy	Prusament PLA Blend Royal Blue 1kg (NFC) ★★★★★ In stock \$105.00 Buy	Prusament PLA Jet Black 1kg (NFC) ★★★★★ In stock \$105.00 Buy	Prusament PLA Prusa Galaxy Black 1kg (NFC) ★★★★★ In stock \$105.00 Buy	Prusament PLA Galaxy Purple 1kg (NFC) ★★★★★ In stock \$105.00 Buy
---	---	--	---	--



Filament

Prusament	Materials clearance sale	Buddy3D Sale	Filament Bundles	PLA	PETG
PC (Polycarbonate)	ASA / ABS	PA (Nylon)	Composites	Flex	Special
Eco					

Filter by **Manufacturer** **Filament color** **NFC compatibility** **Opacity** **Spool type** Sort by Recommended

Prusament PETG Prusa Pro Green 1kg (NFC) ★★★★★ In stock ₪105.00 Buy	Prusament PLA Blend Royal Blue 1kg (NFC) ★★★★★ In stock ₪105.00 Buy	Prusament PLA Jet Black 1kg (NFC) ★★★★★ In stock ₪105.00 Buy	Prusament PLA Prusa Galaxy Black 1kg (NFC) ★★★★★ In stock ₪105.00 Buy	Prusament PLA Galaxy Purple 1kg (NFC) ★★★★★ In stock ₪105.00 Buy
--	--	---	--	---

--	--	--	--	--

Filament types

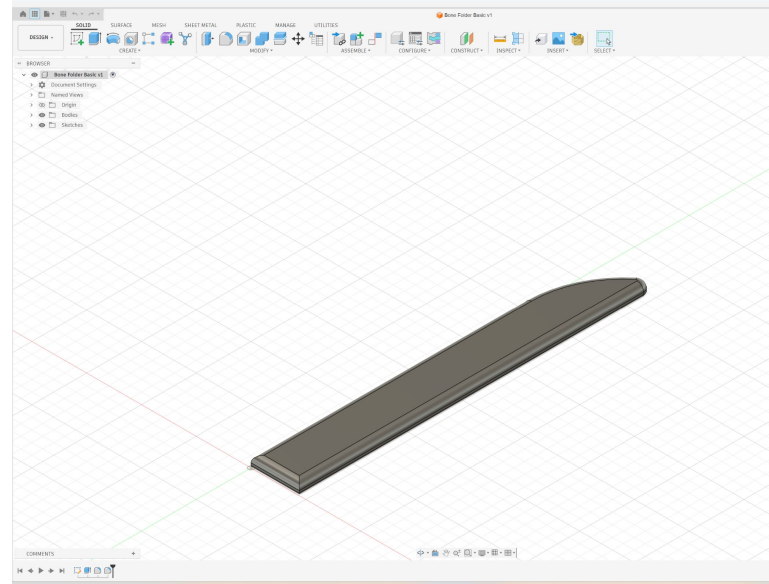

AI Generated

Filaments



PLA

Easy, biodegradable, rigid



PETG

Strong, durable, flexible



TPU

Flexible, rubbery, impact-resistant



ABS

Durable, heat-resistant, machinable

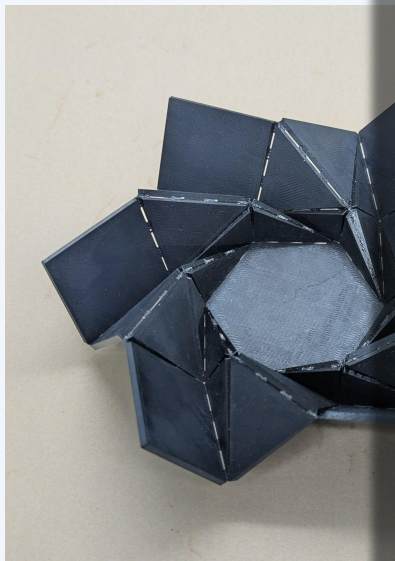

Folded Mode



Peripherals



Peripherals

Paper Cutters

Ynon Toledano

Shai Seger

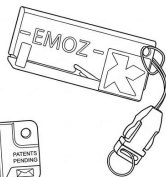
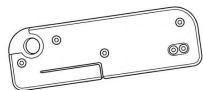
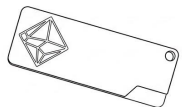

EMOZ

Zimmerman

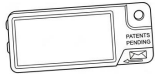

Envelopener



Stands

Joanna Heliora Diva, by
Maria Sinayskaya

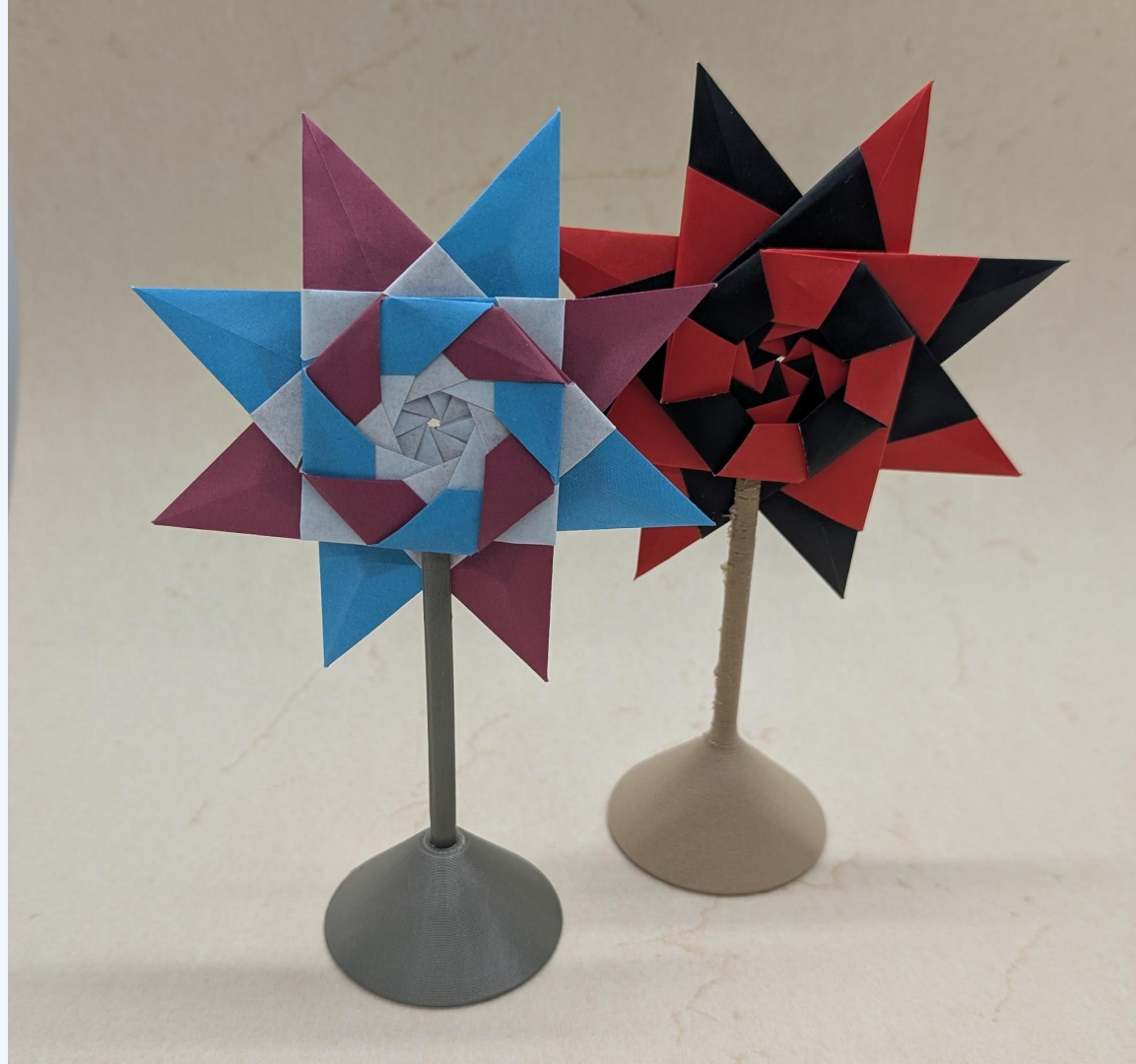

CP Plate

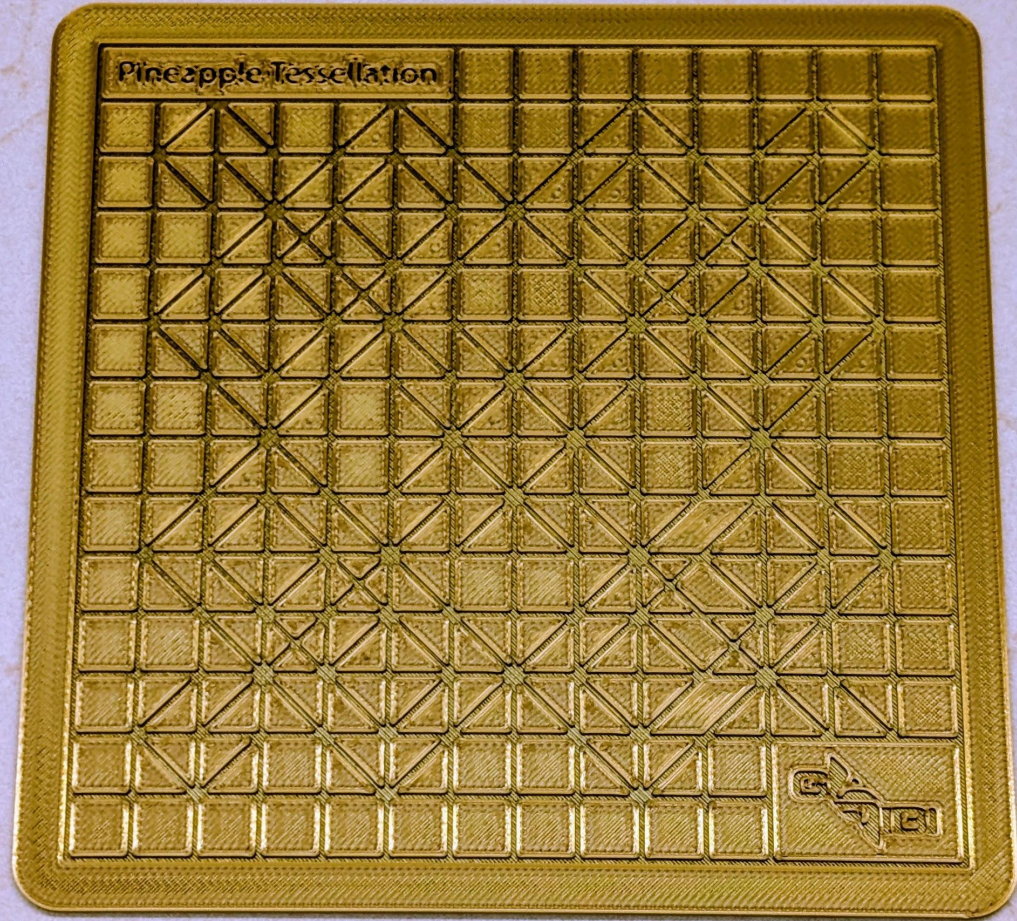

Frame Holder



aribl, israel

Grid-base Shelf

